

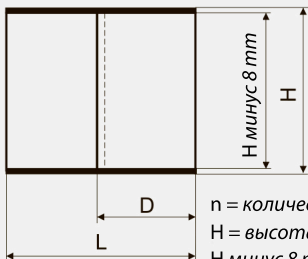

1



$$D = \frac{L + (n-1) \cdot z}{n}$$

$n = 2, 3, 4, \dots$

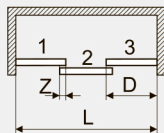

n = количество дверных створок
 H = высота дверного проема
 H минус 8 мм = высота двери

z - 40 mm
рекомендовано

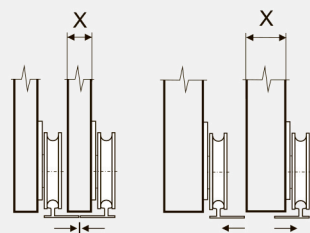

2 A

2 B

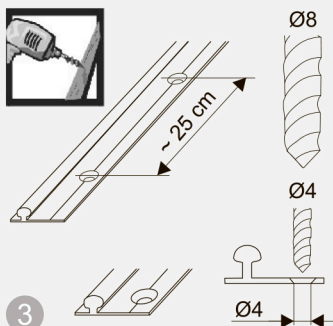

3



$\text{Ø}3,5 \times 16$

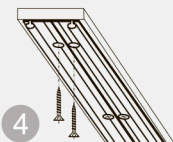

4



$\text{Ø}4 \times 16$

5

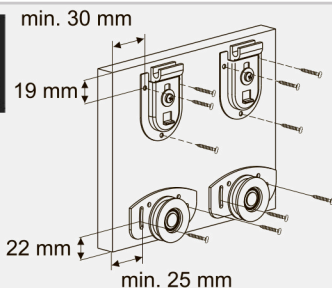

6

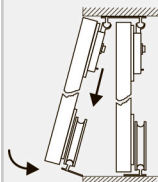

7

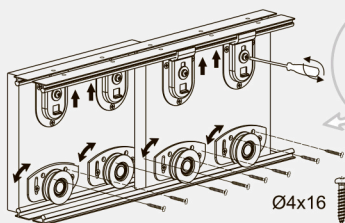

8

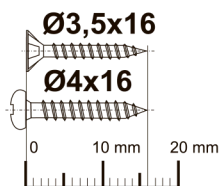
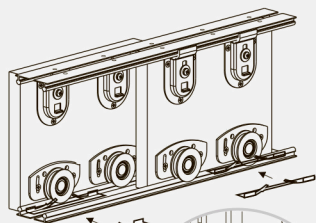
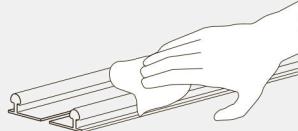

1:1